



M | MANDALAY BAY CONVENTION CENTER

CAPACITIES AND DIMENSIONS



CONVENTIONS ABOVE ALL

Our immense resources allow us to deliver just about anything

your group desires. With 1.7 million square feet of function

space, we offer one of the largest facilities in the country, so we

can accommodate groups of 30 or 30,000! THEhotel gives

the executive-tailored intimacy perfect for groups under 100

attendees. Browse the facts, figures and floor plans and plan your

event in totally flexible space to accommodate your every need.

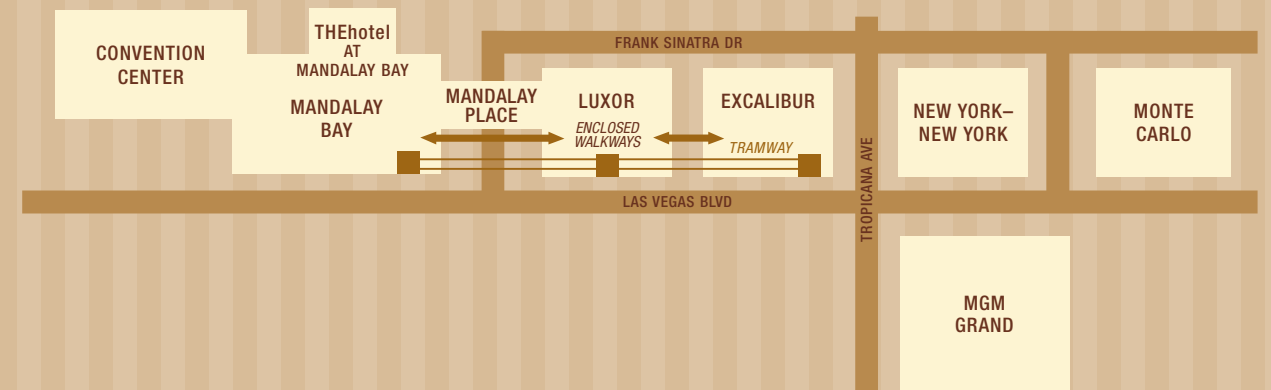

ACCOLADES

"Mandalay Bay is a unique facility that offers a combination of beauty and functionality. The staff is dedicated to delivering top-notch service. This combination doesn't exist elsewhere. We gain a significant advantage over our competition and are able to produce an experience for our attendees that can't be found at any other facility."

-Darel Cook – Director of Expositions, PPAI

"There is always a reason a group returns to the same property year over year. I have been managing corporate conferences since 2005 at Mandalay Bay for groups from 1,500 to 10,000. Every year you seem to exceed my expectations by improving on what I already feel is superb hospitality and service. Keep up the great work! I look forward to continuing our relationship for many years to come."

-Terri Dotson – Senior Project Manager, Meeting Consultants, Inc.

"The Mandalay Bay team delivered on every detail of our event.

Great service, food and facilities . . . we will be back!"

-Jeffrey Calmus – Assistant Vice President, Conference & Event Management, MetLife

"Brilliant team that always delivers world-class service. Mandalay Bay is a true partner."

-Pam Newman – Vice President, Event Management & Approved Supplier Programs, RE/MAX, LLC.

"Mandalay Bay goes above and beyond in contributing to the success of your meeting. They are willing to challenge their way of doing business and go to bat for you, their customer. It's evident they have the success of your meeting in mind and want to ensure everyone has the best experience possible while you are a guest at their hotel."

-Jeannie Garavaglia – Manager, Meetings & Events, MillerCoors

"What sets Mandalay Bay apart is they offer what I consider the 'total package'

. . . a high-quality environment . . . a beautiful place to stay with significant amenities . . . whether it's

dining options, club options, gaming options . . . they are all under one roof . . . our attendees love that."

-Rick McConnell – President, Hanley Wood

SOUTH CONVENTION CENTER LEVEL 1

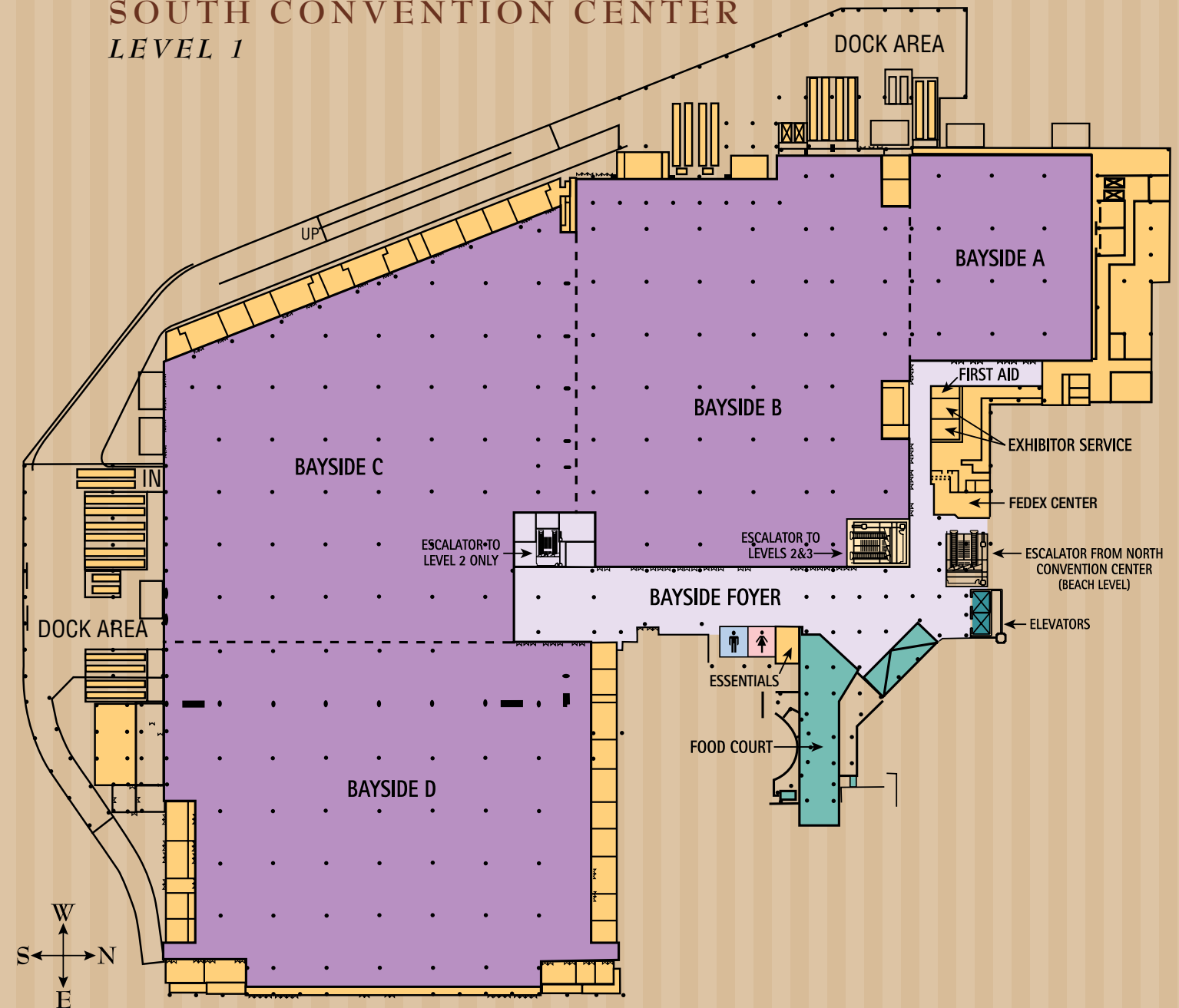

CAPACITIES

SOUTH CONVENTION CENTER - LEVEL 1

| | Square Feet | Dimensions (LxW) | Ceiling Height | 10x10 | Load Limit | Columns Centers |
|-------------------------|-------------|------------------|----------------|-------|------------|-----------------|
| Bayside Exhibition Hall | 577,173 | | 30' | 2,652 | 350lbs | 60' centers N/S |
| Bayside A | 48,722 | 237' x 206' | 30' | 244 | 350lbs | 60' centers E/W |
| Bayside B | 169,587 | 386' x 447' | 30' | 826 | 350lbs | 60' centers E/W |
| Bayside C | 177,929 | 454' x 397' | 30' | 939 | 350lbs | 60' centers E/W |
| Bayside D | 179,718 | 450' x 404' | 30' | 869 | 350lbs | 60' centers E/W |
| Bayside D Office | 1,216 | 32' x 38' | N/A | N/A | N/A | N/A |
| Bayside Foyer | 57,636 | | | | | |

Length = North to South, Width = East to West

SOUTH CONVENTION CENTER LEVEL 2

CAPACITIES SOUTH CONVENTION CENTER - LEVEL 2

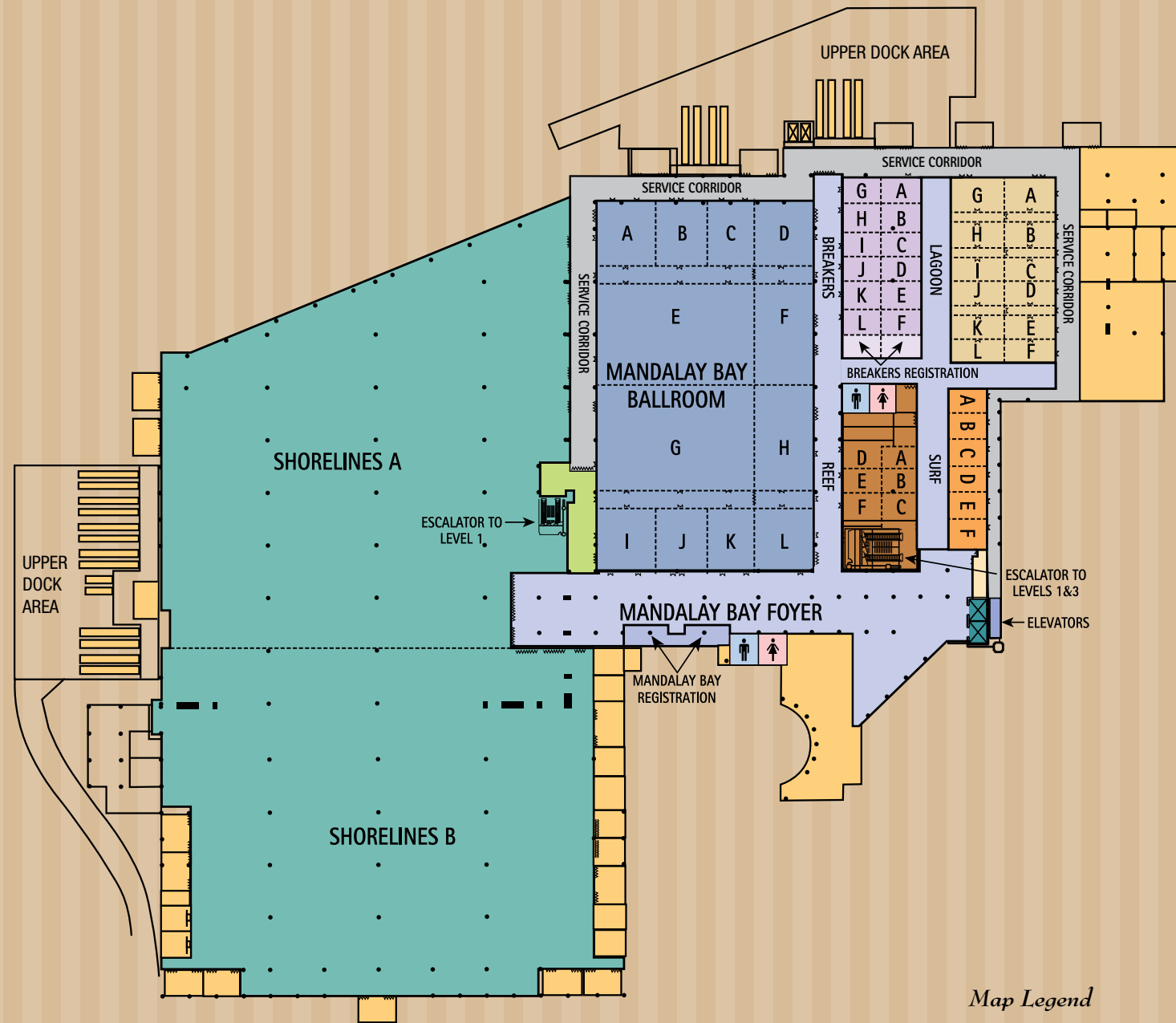

Map Legend

- Men's Room
- Women's Room
- Telephones

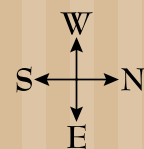

| | Square Feet | Dimensions (LxW) | Ceiling Height | 10x10 | Load Limit | Columns Centers |
|---------------------------|-------------|------------------|----------------|-------|------------|------------------|
| Shoreline Exhibition Hall | 359,133 | 960' x 376' | 30' | 1,789 | 350lbs | 60' centers E/W |
| Shoreline A | 176,341 | 451' x 391' | 30' | 850 | 350lbs | 120' centers N/S |
| Shoreline B | 181,800 | 450' x 404' | 30' | 910 | 350lbs | 120' centers N/S |
| Shoreline B Office | 992 | 32' x 31' | N/A | N/A | N/A | N/A |

| | Square Feet | Dimensions (LxW) | Ceiling Height | Theatre | Classroom | Rounds of 10 | Reception | Conference | Hollow Square |
|--|-------------|------------------|----------------|---------|-----------|--------------|-----------|------------|---------------|
| Mandalay Bay Ballroom | 100,014 | 237' x 422' | 30' | 10,528 | 5,883 | 5,880 | 6,668 | N/A | N/A |
| Corridor 1 | 1,300 | 65' x 20' | 30' | N/A | N/A | N/A | N/A | N/A | N/A |
| Corridor 2 | 3,440 | 172' x 20' | 30' | N/A | N/A | N/A | N/A | N/A | N/A |
| Corridor 3 | 1,300 | 65' x 20' | 30' | N/A | N/A | N/A | N/A | N/A | N/A |
| Corridor 4 | 3,440 | 172' x 20' | 30' | N/A | N/A | N/A | N/A | N/A | N/A |
| Mandalay Bay A | 4,745 | 65' x 73' | 30' | 503 | 281 | 280 | 319 | 60 | 82 |
| Mandalay Bay AB | 8,833 | 121' x 73' | 30' | 934 | 522 | 520 | 592 | N/A | N/A |
| Mandalay Bay ABC | 12,556 | 172' x 73' | 30' | 1,329 | 743 | 740 | 842 | N/A | N/A |
| Mandalay Bay ABCD | 17,301 | 237' x 73' | 30' | 1,834 | 1,025 | 1,030 | 1,161 | N/A | N/A |
| Mandalay Bay ABCDEF | 49,296 | 237' x 208' | 30' | 3,765 | 2,104 | 2,100 | 2,384 | N/A | N/A |
| Mandalay Bay ABCDEFGH | 77,736 | 237' x 328' | 30' | 8,189 | 4,576 | 4,580 | 5,186 | N/A | N/A |
| Mandalay Bay ABCE | 35,766 | 172' x 208' | 30' | 3,765 | 2,104 | 2,100 | 2,384 | N/A | N/A |
| Mandalay Bay ABCEG | 56,416 | 172' x 328' | 30' | 5,934 | 3,316 | 3,320 | 3,758 | N/A | N/A |
| Mandalay Bay ABCEGIJK | 72,584 | 172' x 422' | 30' | 7,629 | 4,263 | 4,260 | 4,832 | N/A | N/A |
| Mandalay Bay B | 4,088 | 56' x 73' | 30' | 433 | 242 | 240 | 274 | 60 | 82 |
| Mandalay Bay BC | 7,811 | 107' x 73' | 30' | 828 | 463 | 460 | 524 | N/A | N/A |
| Mandalay Bay BCD | 12,556 | 172' x 73' | 30' | 1,335 | 746 | 740 | 845 | N/A | N/A |
| Mandalay Bay C | 3,723 | 51' x 73' | 30' | 395 | 220 | 220 | 250 | 60 | 76 |
| Mandalay Bay CD | 8,468 | 116' x 73' | 30' | 897 | 502 | 500 | 568 | N/A | N/A |
| Mandalay Bay D | 4,745 | 65' x 73' | 30' | 503 | 281 | 280 | 319 | 60 | 80 |
| Mandalay Bay E | 19,780 | 172' x 115' | 30' | 2,082 | 1,164 | 1,160 | 1,319 | N/A | N/A |
| Mandalay Bay EF | 27,255 | 237' x 115' | 30' | 2,863 | 1,600 | 1,600 | 1,813 | N/A | N/A |
| Mandalay Bay EFGH | 55,695 | 237' x 235' | 30' | 5,844 | 3,266 | 3,270 | 3,701 | N/A | N/A |
| Mandalay Bay EFGHIJKL | 77,736 | 237' x 328' | 30' | 7,983 | 4,461 | 4,460 | 5,056 | N/A | N/A |
| Mandalay Bay EG | 40,420 | 172' x 235' | 30' | 4,099 | 2,291 | 2,290 | 2,596 | N/A | N/A |
| Mandalay Bay EGJK | 56,416 | 172' x 328' | 30' | 5,604 | 3,132 | 3,130 | 3,549 | N/A | N/A |
| Mandalay Bay F | 7,475 | 65' x 115' | 30' | 787 | 440 | 440 | 498 | N/A | N/A |
| Mandalay Bay FH | 15,275 | 65' x 235' | 30' | 1,606 | 898 | 900 | 1,017 | N/A | N/A |
| Mandalay Bay G | 20,640 | 172' x 120' | 30' | 2,173 | 1,214 | 1,210 | 1,376 | N/A | N/A |
| Mandalay Bay GH | 28,440 | 237' x 120' | 30' | 2,994 | 1,673 | 1,670 | 1,896 | N/A | N/A |
| Mandalay Bay GHIJKL | 50,481 | 237' x 213' | 30' | 5,120 | 2,861 | 2,860 | 3,243 | N/A | N/A |
| Mandalay Bay GIJK | 36,636 | 172' x 213' | 30' | 3,698 | 2,067 | 2,070 | 2,342 | N/A | N/A |
| Mandalay Bay H | 7,800 | 65' x 120' | 30' | 821 | 459 | 460 | 520 | N/A | N/A |
| Mandalay Bay I | 4,745 | 65' x 73' | 30' | 503 | 281 | 280 | 319 | 60 | 80 |
| Mandalay Bay IJ | 8,833 | 121' x 73' | 30' | 892 | 498 | 500 | 565 | N/A | N/A |
| Mandalay Bay IJK | 12,556 | 172' x 73' | 30' | 1,286 | 719 | 720 | 815 | N/A | N/A |
| Mandalay Bay IJKL | 17,301 | 237' x 73' | 30' | 1,834 | 1,025 | 1,030 | 1,161 | N/A | N/A |
| Mandalay Bay J | 4,088 | 56' x 73' | 30' | 433 | 242 | 240 | 274 | 60 | 76 |
| Mandalay Bay JK | 7,811 | 107' x 73' | 30' | 828 | 463 | 460 | 524 | N/A | N/A |
| Mandalay Bay JKL | 12,556 | 172' x 73' | 30' | 1,333 | 745 | 750 | 844 | N/A | N/A |
| Mandalay Bay K | 3,723 | 51' x 73' | 30' | 387 | 216 | 220 | 245 | 60 | 70 |
| Mandalay Bay KL | 8,468 | 116' x 73' | 30' | 899 | 503 | 500 | 570 | N/A | N/A |
| Mandalay Bay L | 4,745 | 65' x 73' | 30' | 503 | 281 | 280 | 319 | 60 | 82 |
| Mandalay Foyer | 50,220 | 540' x 93' | N/A | N/A | N/A | N/A | 3,348 | N/A | N/A |
| Mandalay Bay Registration North (Office) | 280 | 40' x 7' | 12' | N/A | N/A | N/A | N/A | N/A | N/A |
| Mandalay Bay Registration North (Desk) | 400 | 40' x 10' | N/A | N/A | N/A | N/A | N/A | N/A | N/A |
| Mandalay Bay Registration South (Office) | 828 | 46' x 18' | 12' | N/A | N/A | N/A | N/A | N/A | N/A |
| Mandalay Bay Registration South (Desk) | 410 | 41' x 10' | N/A | N/A | N/A | N/A | N/A | N/A | N/A |

Length = North to South, Width = East to West

Classroom seating based on 3 people per 6' table.

Capacities are subject to change based on allowances for head tables, staging, audiovisual, and catering requirements.

CAPACITIES
SOUTH CONVENTION CENTER - LEVEL 2 CONTINUED

| | Square Feet | Dimensions (LxW) | Ceiling Height | Theatre | Classroom | Rounds of 10 | Reception | Conference | Hollow Square |
|----------------------|-------------|------------------|----------------|---------|-----------|--------------|-----------|------------|---------------|
| Breakers | 15,138 | 87' x 174' | 18' | 1,621 | 906 | 910 | 1,027 | N/A | N/A |
| Breakers A | 1,260 | 45' x 28' | 18' | 130 | 73 | 70 | 83 | 36 | 46 |
| Breakers AB | 2,745 | 45' x 61' | 18' | 294 | 164 | 160 | 186 | N/A | N/A |
| Breakers ABC | 3,915 | 45' x 87' | 18' | 417 | 233 | 230 | 264 | N/A | N/A |
| Breakers ABCD | 5,085 | 45' x 113' | 18' | 541 | 302 | 300 | 343 | N/A | N/A |
| Breakers ABCDE | 6,570 | 45' x 146' | 18' | 701 | 392 | 390 | 444 | N/A | N/A |
| Breakers ABCDEF | 7,830 | 45' x 174' | 18' | 838 | 469 | 470 | 531 | N/A | N/A |
| Breakers ABGH | 5,307 | 87' x 61' | 18' | 568 | 317 | 320 | 360 | N/A | N/A |
| Breakers ABCGHI | 7,569 | 87' x 87' | 18' | 806 | 450 | 450 | 510 | N/A | N/A |
| Breakers ABCDGHIJ | 9,831 | 87' x 113' | 18' | 1,046 | 585 | 590 | 663 | N/A | N/A |
| Breakers ABCDEFGHIJK | 12,702 | 87' x 146' | 18' | 1,355 | 757 | 760 | 858 | N/A | N/A |
| Breakers AG | 2,436 | 87' x 28' | 18' | 252 | 141 | 140 | 159 | N/A | N/A |
| Breakers B | 1,485 | 45' x 33' | 18' | 152 | 85 | 90 | 96 | 36 | 46 |
| Breakers BC | 2,655 | 45' x 59' | 18' | 279 | 156 | 160 | 177 | N/A | N/A |
| Breakers BCD | 3,825 | 45' x 85' | 18' | 403 | 225 | 230 | 255 | N/A | N/A |
| Breakers BCDE | 5,310 | 45' x 118' | 18' | 564 | 315 | 320 | 357 | N/A | N/A |
| Breakers BCDEF | 6,570 | 45' x 146' | 18' | 700 | 391 | 390 | 443 | N/A | N/A |
| Breakers BCHI | 5,133 | 87' x 59' | 18' | 540 | 302 | 300 | 342 | N/A | N/A |
| Breakers BCDHIJ | 7,395 | 87' x 85' | 18' | 778 | 435 | 440 | 493 | N/A | N/A |
| Breakers BCDEHIJK | 10,266 | 87' x 118' | 18' | 1,090 | 609 | 610 | 690 | N/A | N/A |
| Breakers BCDEFHIJKL | 12,702 | 87' x 146' | 18' | 1,353 | 756 | 760 | 857 | N/A | N/A |
| Breakers BH | 2,871 | 87' x 33' | 18' | 293 | 164 | 160 | 186 | N/A | N/A |
| Breakers C | 1,170 | 45' x 26' | 18' | 130 | 73 | 70 | 83 | 36 | 46 |
| Breakers CD | 2,340 | 45' x 52' | 18' | 246 | 138 | 140 | 156 | N/A | N/A |
| Breakers CDE | 3,825 | 45' x 85' | 18' | 407 | 228 | 230 | 258 | N/A | N/A |
| Breakers CDEF | 5,085 | 45' x 113' | 18' | 542 | 303 | 300 | 343 | N/A | N/A |
| Breakers CDIJ | 4,524 | 87' x 52' | 18' | 476 | 266 | 270 | 302 | N/A | N/A |
| Breakers CDEIJK | 7,395 | 87' x 85' | 18' | 788 | 440 | 440 | 499 | N/A | N/A |
| Breakers CDEFIJKL | 9,831 | 87' x 113' | 18' | 1,049 | 586 | 590 | 664 | N/A | N/A |
| Breakers CI | 2,262 | 87' x 26' | 18' | 252 | 141 | 140 | 159 | N/A | N/A |
| Breakers D | 1,170 | 45' x 26' | 18' | 130 | 73 | 70 | 83 | 36 | 46 |
| Breakers DE | 2,655 | 45' x 59' | 18' | 283 | 158 | 160 | 179 | N/A | N/A |
| Breakers DEF | 3,915 | 45' x 87' | 18' | 418 | 234 | 230 | 265 | N/A | N/A |
| Breakers DEJK | 5,133 | 87' x 59' | 18' | 547 | 306 | 310 | 347 | N/A | N/A |
| Breakers DEFJKL | 7,569 | 87' x 87' | 18' | 808 | 452 | 450 | 512 | N/A | N/A |
| Breakers DJ | 2,262 | 87' x 26' | 18' | 252 | 141 | 140 | 159 | N/A | N/A |
| Breakers E | 1,485 | 45' x 33' | 18' | 149 | 83 | 90 | 95 | 36 | 46 |
| Breakers EF | 2,745 | 45' x 61' | 18' | 294 | 164 | 160 | 186 | N/A | N/A |
| Breakers EFKL | 5,307 | 87' x 61' | 18' | 568 | 317 | 320 | 360 | N/A | N/A |
| Breakers EK | 2,871 | 87' x 33' | 18' | 288 | 161 | 160 | 183 | N/A | N/A |
| Breakers F | 1,260 | 45' x 28' | 18' | 135 | 75 | 80 | 86 | 36 | 46 |
| Breakers FL | 2,436 | 87' x 28' | 18' | 261 | 146 | 150 | 165 | N/A | N/A |
| Breakers G | 1,176 | 42' x 28' | 18' | 122 | 68 | 70 | 77 | 34 | 42 |
| Breakers GH | 2,562 | 42' x 61' | 18' | 274 | 153 | 150 | 174 | N/A | N/A |
| Breakers GHI | 3,654 | 42' x 87' | 18' | 389 | 217 | 220 | 246 | N/A | N/A |
| Breakers GHIJ | 4,746 | 42' x 113' | 18' | 505 | 282 | 280 | 320 | N/A | N/A |
| Breakers GHIJK | 6,132 | 42' x 146' | 18' | 654 | 366 | 370 | 414 | N/A | N/A |
| Breakers GHIJKL | 7,308 | 42' x 174' | 18' | 783 | 437 | 440 | 496 | N/A | N/A |
| Breakers H | 1,386 | 42' x 33' | 18' | 141 | 79 | 80 | 90 | 34 | 42 |
| Breakers HI | 2,478 | 42' x 59' | 18' | 261 | 146 | 150 | 165 | N/A | N/A |
| Breakers HIJ | 3,570 | 42' x 85' | 18' | 376 | 210 | 210 | 238 | N/A | N/A |
| Breakers HIJK | 4,956 | 42' x 118' | 18' | 526 | 294 | 290 | 333 | N/A | N/A |
| Breakers HIJKL | 6,132 | 42' x 146' | 18' | 652 | 364 | 360 | 413 | N/A | N/A |
| Breakers I | 1,092 | 42' x 26' | 18' | 122 | 68 | 60 | 77 | 34 | 42 |
| Breakers IJ | 2,184 | 42' x 52' | 18' | 230 | 128 | 130 | 146 | N/A | N/A |

Length = North to South, Width = East to West
Classroom seating based on 3 people per 6' table.
Capacities are subject to change based on allowances for head tables, staging, audiovisual, and catering requirements.

CAPACITIES
SOUTH CONVENTION CENTER - LEVEL 2 CONTINUED

| | Square Feet | Dimensions (LxW) | Ceiling Height | Theatre | Classroom | Rounds of 10 | Reception | Conference | Hollow Square |
|--------------------------------------|-------------|------------------|----------------|---------|-----------|--------------|-----------|------------|---------------|
| Breakers IJK | 3,570 | 42' x 85' | 18' | 380 | 212 | 210 | 241 | N/A | N/A |
| Breakers IJKL | 4,746 | 42' x 113' | 18' | 506 | 283 | 280 | 321 | N/A | N/A |
| Breakers J | 1,092 | 42' x 26' | 18' | 122 | 68 | 60 | 77 | 34 | 42 |
| Breakers JK | 2,478 | 42' x 59' | 18' | 264 | 148 | 150 | 167 | N/A | N/A |
| Breakers JKL | 3,654 | 42' x 87' | 18' | 390 | 218 | 220 | 247 | N/A | N/A |
| Breakers K | 1,386 | 42' x 33' | 18' | 139 | 78 | 80 | 88 | 34 | 42 |
| Breakers KL | 2,562 | 42' x 61' | 18' | 274 | 153 | 150 | 174 | N/A | N/A |
| Breakers L | 1,176 | 42' x 28' | 18' | 126 | 70 | 70 | 80 | 34 | 42 |
| Breakers Foyer | 2,700 | 90' x 30' | N/A | N/A | N/A | N/A | 180 | N/A | N/A |
| Breakers Registration North (Office) | 828 | 46' x 18' | 12' | N/A | N/A | N/A | N/A | N/A | N/A |
| Breakers Registration North (Desk) | 440 | 40' x 11' | N/A | N/A | N/A | N/A | N/A | N/A | N/A |
| Breakers Registration South (Office) | 828 | 46' x 18' | 12' | N/A | N/A | N/A | N/A | N/A | N/A |
| Breakers Registration South (Desk) | 440 | 40' x 11' | N/A | N/A | N/A | N/A | N/A | N/A | N/A |

| | Square Feet | Dimensions (LxW) | Ceiling Height | Theatre | Classroom | Rounds of 10 | Reception | Conference | Hollow Square |
|------------|-------------|------------------|----------------|---------|-----------|--------------|-----------|------------|---------------|
| Surf | 7,920 | 44' x 180' | 18' | 845 | 472 | 470 | 535 | N/A | N/A |
| Surf A | 1,276 | 44' x 29' | 18' | 132 | 74 | 80 | 84 | 34 | 43 |
| Surf AB | 2,596 | 44' x 59' | 18' | 277 | 155 | 160 | 175 | N/A | N/A |
| Surf ABC | 3,916 | 44' x 89' | 18' | 416 | 232 | 230 | 263 | N/A | N/A |
| Surf ABCD | 5,148 | 44' x 117' | 18' | 548 | 306 | 310 | 347 | N/A | N/A |
| Surf ABCDE | 6,468 | 44' x 147' | 18' | 687 | 384 | 380 | 435 | N/A | N/A |
| Surf B | 1,320 | 44' x 30' | 18' | 139 | 78 | 80 | 88 | 34 | 43 |
| Surf BC | 2,640 | 44' x 60' | 18' | 278 | 155 | 160 | 176 | N/A | N/A |
| Surf BCD | 3,872 | 44' x 88' | 18' | 417 | 233 | 230 | 264 | N/A | N/A |
| Surf BCDE | 5,192 | 44' x 118' | 18' | 556 | 311 | 310 | 352 | N/A | N/A |
| Surf BCDEF | 6,644 | 44' x 151' | 18' | 695 | 388 | 390 | 440 | N/A | N/A |
| Surf C | 1,320 | 44' x 30' | 18' | 139 | 78 | 80 | 88 | 34 | 43 |
| Surf CD | 2,552 | 44' x 58' | 18' | 278 | 155 | 160 | 176 | N/A | N/A |
| Surf CDE | 3,872 | 44' x 88' | 18' | 417 | 233 | 230 | 264 | N/A | N/A |
| Surf CDEF | 5,324 | 44' x 121' | 18' | 556 | 311 | 310 | 352 | N/A | N/A |
| Surf D | 1,232 | 44' x 28' | 18' | 139 | 78 | 80 | 88 | 34 | 43 |
| Surf DE | 2,552 | 44' x 58' | 18' | 278 | 155 | 160 | 176 | N/A | N/A |
| Surf DEF | 4,004 | 44' x 91' | 18' | 417 | 233 | 230 | 264 | N/A | N/A |
| Surf E | 1,320 | 44' x 30' | 18' | 139 | 78 | 80 | 88 | 34 | 43 |
| Surf EF | 2,772 | 44' x 63' | 18' | 278 | 155 | 160 | 176 | N/A | N/A |
| Surf F | 1,452 | 44' x 30' | 18' | 139 | 78 | 90 | 88 | 34 | 43 |
| Surf Foyer | 7,200 | 240' x 30' | N/A | N/A | N/A | N/A | 480 | N/A | N/A |

| | Square Feet | Dimensions (LxW) | Ceiling Height | Theatre | Classroom | Rounds of 10 | Reception | Conference | Hollow Square |
|---------------|-------------|------------------|----------------|---------|-----------|--------------|-----------|------------|---------------|
| Lagoon | 23,985 | 117' x 205' | 18' | 2,549 | 1,425 | 1,430 | 1,615 | N/A | N/A |
| Corridor 1 | 840 | 15' x 56' | 18' | N/A | N/A | N/A | N/A | N/A | N/A |
| Corridor 2 | 915 | 15' x 61' | 18' | N/A | N/A | N/A | N/A | N/A | N/A |
| Corridor 3 | 840 | 15' x 56' | 18' | N/A | N/A | N/A | N/A | N/A | N/A |
| Corridor 4 | 915 | 15' x 61' | 18' | N/A | N/A | N/A | N/A | N/A | N/A |
| Corridor 5 | 840 | 15' x 56' | 18' | N/A | N/A | N/A | N/A | N/A | N/A |
| Corridor 6 | 915 | 15' x 61' | 18' | N/A | N/A | N/A | N/A | N/A | N/A |
| Lagoon A | 1,848 | 56' x 33' | 18' | 212 | 119 | 120 | 134 | 44 | 54 |
| Lagoon AB | 4,200 | 56' x 75' | 18' | 445 | 249 | 250 | 282 | N/A | N/A |
| Lagoon ABC | 6,384 | 56' x 114' | 18' | 673 | 376 | 380 | 427 | N/A | N/A |
| Lagoon ABCD | 7,784 | 56' x 139' | 18' | 824 | 460 | 460 | 522 | N/A | N/A |
| Lagoon ABCDE | 10,136 | 56' x 181' | 18' | 1,073 | 600 | 600 | 679 | N/A | N/A |
| Lagoon ABCDEF | 11,480 | 56' x 205' | 18' | 1,220 | 682 | 680 | 773 | N/A | N/A |

Length = North to South, Width = East to West
Classroom seating based on 3 people per 6' table.
Capacities are subject to change based on allowances for head tables, staging, audiovisual, and catering requirements.

CAPACITIES SOUTH CONVENTION CENTER - LEVEL 2 CONTINUED

| | Square Feet | Dimensions (LxW) | Ceiling Height | Theatre | Classroom | Rounds of 10 | Reception | Conference | Hollow Square |
|-------------------|-------------|------------------|----------------|---------|-----------|--------------|-----------|------------|---------------|
| Lagoon AG | 3,861 | 117' x 33' | 18' | 443 | 248 | 250 | 281 | N/A | N/A |
| Lagoon ABGH | 8,775 | 117' x 75' | 18' | 927 | 518 | 520 | 587 | N/A | N/A |
| Lagoon ABCGHI | 13,338 | 117' x 114' | 18' | 1,407 | 786 | 790 | 891 | N/A | N/A |
| Lagoon ABCDGHJI | 16,263 | 117' x 139' | 18' | 1,718 | 960 | 960 | 1,088 | N/A | N/A |
| Lagoon ABCDEGHIJK | 21,177 | 117' x 181' | 18' | 2,241 | 1,253 | 1,250 | 1,420 | N/A | N/A |
| Lagoon B | 1,512 | 56' x 27' | 18' | 171 | 96 | 100 | 108 | 44 | 54 |
| Lagoon BC | 3,696 | 56' x 66' | 18' | 392 | 219 | 220 | 248 | N/A | N/A |
| Lagoon BCD | 5,096 | 56' x 91' | 18' | 539 | 301 | 300 | 342 | N/A | N/A |
| Lagoon BCDE | 7,448 | 56' x 133' | 18' | 790 | 441 | 440 | 500 | N/A | N/A |
| Lagoon BCDEF | 8,792 | 56' x 157' | 18' | 936 | 523 | 520 | 593 | N/A | N/A |
| Lagoon BH | 3,159 | 117' x 27' | 18' | 357 | 200 | 200 | 226 | N/A | N/A |
| Lagoon BCHI | 7,722 | 117' x 66' | 18' | 819 | 458 | 460 | 519 | N/A | N/A |
| Lagoon BCDHIJ | 10,647 | 117' x 91' | 18' | 1,127 | 630 | 630 | 714 | N/A | N/A |
| Lagoon BCDEHIJK | 15,561 | 117' x 133' | 18' | 1,650 | 922 | 920 | 1,045 | N/A | N/A |
| Lagoon BCDEFHIJKL | 18,369 | 117' x 157' | 18' | 1,955 | 1,093 | 1,090 | 1,238 | N/A | N/A |
| Lagoon C | 1,344 | 56' x 24' | 18' | 156 | 87 | 90 | 99 | 44 | 54 |
| Lagoon CD | 2,744 | 56' x 49' | 18' | 290 | 162 | 160 | 184 | N/A | N/A |
| Lagoon CDE | 5,096 | 56' x 91' | 18' | 539 | 301 | 300 | 342 | N/A | N/A |
| Lagoon CDEF | 6,440 | 56' x 115' | 18' | 687 | 384 | 380 | 435 | N/A | N/A |
| Lagoon CI | 2,808 | 117' x 24' | 18' | 326 | 182 | 180 | 207 | N/A | N/A |
| Lagoon CDIJ | 5,733 | 117' x 49' | 18' | 607 | 339 | 340 | 384 | N/A | N/A |
| Lagoon CDEIJK | 10,647 | 117' x 91' | 18' | 1,127 | 630 | 630 | 714 | N/A | N/A |
| Lagoon CDEFJKL | 13,455 | 117' x 115' | 18' | 1,435 | 802 | 800 | 909 | N/A | N/A |
| Lagoon D | 1,400 | 56' x 25' | 18' | 156 | 87 | 90 | 99 | 44 | 54 |
| Lagoon DE | 3,752 | 56' x 67' | 18' | 398 | 222 | 220 | 252 | N/A | N/A |
| Lagoon DEF | 5,096 | 56' x 91' | 18' | 542 | 303 | 300 | 343 | N/A | N/A |
| Lagoon DJ | 2,925 | 117' x 25' | 18' | 326 | 182 | 170 | 207 | N/A | N/A |
| Lagoon DEJK | 7,839 | 117' x 67' | 18' | 831 | 465 | 470 | 526 | N/A | N/A |
| Lagoon DEFJKL | 10,647 | 117' x 91' | 18' | 1,133 | 633 | 630 | 718 | N/A | N/A |
| Lagoon E | 1,512 | 56' x 27' | 18' | 150 | 84 | 80 | 95 | 44 | 54 |
| Lagoon EF | 2,856 | 56' x 51' | 18' | 308 | 172 | 172 | 195 | N/A | N/A |
| Lagoon EK | 3,159 | 117' x 27' | 18' | 314 | 175 | 180 | 199 | N/A | N/A |
| Lagoon EFKL | 5,967 | 117' x 51' | 18' | 643 | 360 | 360 | 408 | N/A | N/A |
| Lagoon F | 1,344 | 56' x 24' | 18' | 153 | 86 | 90 | 97 | 44 | 54 |
| Lagoon FL | 2,808 | 117' x 24' | 18' | 320 | 179 | 180 | 203 | N/A | N/A |
| Lagoon G | 2,013 | 61' x 33' | 18' | 231 | 129 | 130 | 146 | 48 | 54 |
| Lagoon GH * | 4,575 | 61' x 75' | 18' | 483 | 270 | 270 | 306 | N/A | N/A |
| Lagoon GHI * | 6,954 | 61' x 114' | 18' | 737 | 412 | 410 | 467 | N/A | N/A |
| Lagoon GHIJ * | 8,479 | 61' x 139' | 18' | 896 | 501 | 500 | 567 | N/A | N/A |
| Lagoon GHIJK * | 11,041 | 61' x 181' | 18' | 1,169 | 653 | 650 | 740 | N/A | N/A |
| Lagoon GHIJKL * | 12,505 | 61' x 205' | 18' | 1,329 | 743 | 740 | 842 | N/A | N/A |
| Lagoon H | 1,647 | 61' x 27' | 18' | 186 | 104 | 100 | 118 | 48 | 52 |
| Lagoon HI * | 4,026 | 61' x 66' | 18' | 427 | 239 | 240 | 270 | N/A | N/A |
| Lagoon HIJ * | 5,551 | 61' x 91' | 18' | 587 | 328 | 330 | 372 | N/A | N/A |
| Lagoon HIJK * | 8,113 | 61' x 133' | 18' | 860 | 481 | 480 | 545 | N/A | N/A |
| Lagoon HIJKL * | 9,577 | 61' x 157' | 18' | 1,019 | 570 | 570 | 646 | N/A | N/A |
| Lagoon I | 1,464 | 61' x 24' | 18' | 170 | 95 | 100 | 108 | 48 | 56 |
| Lagoon IJ | 2,989 | 61' x 49' | 18' | 316 | 177 | 180 | 200 | N/A | N/A |
| Lagoon IJK * | 5,551 | 61' x 91' | 18' | 587 | 328 | 330 | 372 | N/A | N/A |
| Lagoon IJKL * | 7,015 | 61' x 115' | 18' | 748 | 418 | 420 | 474 | N/A | N/A |
| Lagoon J | 1,525 | 61' x 25' | 18' | 170 | 95 | 100 | 108 | 48 | 56 |
| Lagoon JK * | 4,087 | 61' x 67' | 18' | 433 | 242 | 240 | 274 | N/A | N/A |
| Lagoon JKL * | 5,551 | 61' x 91' | 18' | 591 | 330 | 330 | 374 | N/A | N/A |
| Lagoon K | 1,647 | 61' x 27' | 18' | 164 | 92 | 90 | 104 | 48 | 56 |
| Lagoon KL | 3,111 | 61' x 51' | 18' | 335 | 187 | 190 | 212 | N/A | N/A |
| Lagoon L | 1,464 | 61' x 24' | 18' | 167 | 93 | 90 | 106 | 48 | 56 |
| Lagoon Foyer West | 7,200 | 240' x 30' | N/A | N/A | N/A | N/A | 480 | N/A | N/A |

Length = North to South, Width = East to West
Classroom seating based on 3 people per 6' table.

Capacities are subject to change based on allowances for head tables, staging, audiovisual, and catering requirements.

*Some room combinations may limit access to other rooms.

CAPACITIES SOUTH CONVENTION CENTER - LEVEL 2 CONTINUED

| | Square Feet | Dimensions (LxW) | Ceiling Height | Theatre | Classroom | Rounds of 10 | Reception | Conference | Hollow Square |
|-----------|-------------|------------------|----------------|---------|-----------|--------------|-----------|------------|---------------|
| Reef | 6,708 | 86' x 78' | 18' | 824 | 461 | 460 | 522 | N/A | N/A |
| Reef A | 817 | 43' x 19' | 18' | 92 | 51 | 50 | 58 | 35 | 40 |
| Reef AB | 2,107 | 43' x 49' | 18' | 224 | 125 | 130 | 142 | N/A | N/A |
| Reef ABC | 3,354 | 43' x 78' | 18' | 385 | 215 | 220 | 244 | N/A | N/A |
| Reef AD | 1,634 | 86' x 19' | 18' | 252 | 141 | 140 | 159 | N/A | N/A |
| Reef ABDE | 4,214 | 86' x 49' | 18' | 513 | 287 | 290 | 325 | N/A | N/A |
| Reef B | 1,290 | 43' x 30' | 18' | 137 | 77 | 80 | 87 | 35 | 44 |
| Reef BC | 2,537 | 43' x 59' | 18' | 295 | 165 | 170 | 187 | N/A | N/A |
| Reef BE | 2,580 | 86' x 30' | 18' | 275 | 154 | 154 | 174 | N/A | N/A |
| Reef BCEF | 5,074 | 86' x 59' | 18' | 591 | 330 | 330 | 374 | N/A | N/A |
| Reef C | 1,247 | 43' x 29' | 18' | 149 | 83 | 90 | 94 | 35 | 44 |
| Reef CF | 2,494 | 86' x 29' | 18' | 298 | 166 | 170 | 188 | N/A | N/A |
| Reef D | 817 | 43' x 19' | 18' | 126 | 70 | 70 | 80 | 35 | 44 |
| Reef DE | 2,107 | 43' x 49' | 18' | 256 | 143 | 140 | 162 | N/A | N/A |
| Reef DEF | 3,354 | 43' x 78' | 18' | 412 | 230 | 230 | 261 | N/A | N/A |
| Reef E | 1,290 | 43' x 30' | 18' | 137 | 77 | 80 | 87 | 35 | 44 |
| Reef EF | 2,537 | 43' x 59' | 18' | 295 | 165 | 170 | 187 | N/A | N/A |
| Reef F | 1,247 | 43' x 29' | 18' | 149 | 83 | 90 | 94 | 35 | 44 |

Length = North to South, Width = East to West

Classroom seating based on 3 people per 6' table.
Capacities are subject to change based on allowances for head tables, staging, audiovisual, and catering requirements.



LEVEL 3

CAPACITIES
SOUTH CONVENTION CENTER - LEVEL 3

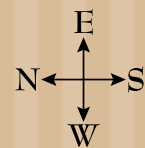
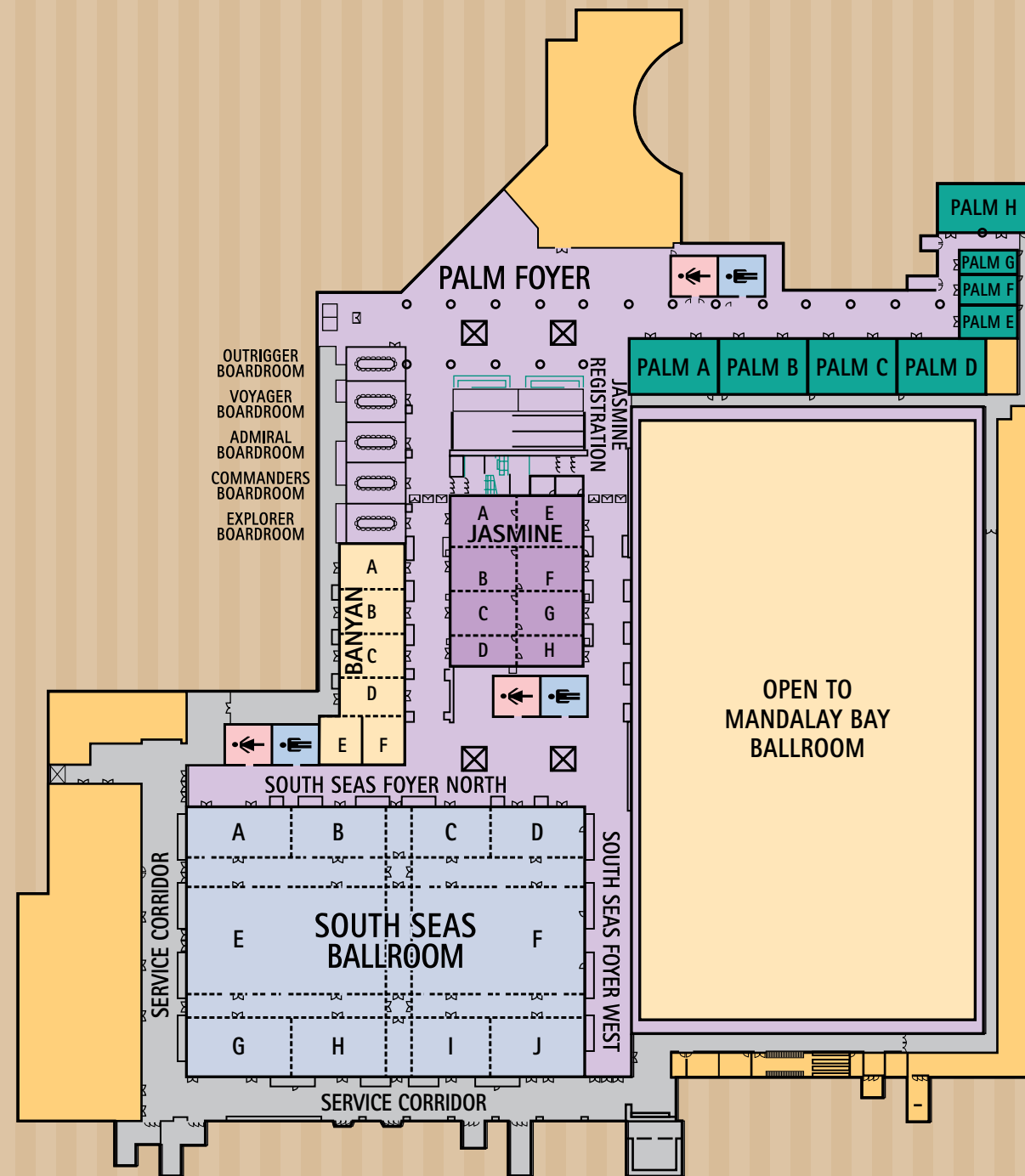

| | Square Feet | Dimensions (LxW) | Ceiling Height | Theatre | Classroom | Rounds of 10 | Reception | Conference | Hollow Square |
|----------------------|-------------|------------------|----------------|---------|-----------|--------------|-----------|------------|---------------|
| Admirals Boardroom | 1,204 | 43' x 28' | 18' | N/A | N/A | N/A | N/A | 20 | N/A |
| Commanders Boardroom | 1,204 | 43' x 28' | 18' | N/A | N/A | N/A | N/A | 20 | N/A |
| Explorers Boardroom | 1,204 | 43' x 28' | 18' | N/A | N/A | N/A | N/A | 20 | N/A |
| Outriggers Boardroom | 903 | 43' x 21' | 18' | N/A | N/A | N/A | N/A | 18 | N/A |
| Voyager Boardroom | 1,204 | 43' x 28' | 18' | N/A | N/A | N/A | N/A | 20 | N/A |

| | Square Feet | Dimensions (LxW) | Ceiling Height | Theatre | Classroom | Rounds of 10 | Reception | Conference | Hollow Square |
|---------------------------------|-------------|------------------|----------------|---------|-----------|--------------|-----------|------------|---------------|
| Jasmine | 9,374 | 86' x 109' | 18' | 1,113 | 622 | 620 | 705 | N/A | N/A |
| Jasmine A | 1,247 | 43' x 29' | 18' | 153 | 86 | 90 | 97 | 34 | 44 |
| Jasmine AB | 2,537 | 43' x 59' | 18' | 295 | 165 | 170 | 187 | N/A | N/A |
| Jasmine ABC | 3,827 | 43' x 89' | 18' | 433 | 242 | 240 | 274 | N/A | N/A |
| Jasmine ABCD | 4,687 | 43' x 109' | 18' | 556 | 311 | 310 | 352 | N/A | N/A |
| Jasmine AE | 2,494 | 86' x 29' | 18' | 307 | 171 | 170 | 194 | N/A | N/A |
| Jasmine ABEF | 5,074 | 86' x 59' | 18' | 591 | 330 | 330 | 374 | N/A | N/A |
| Jasmine ABCEFG | 7,654 | 86' x 89' | 18' | 865 | 484 | 480 | 548 | N/A | N/A |
| Jasmine B | 1,290 | 43' x 30' | 18' | 138 | 77 | 80 | 87 | 34 | 42 |
| Jasmine BC | 2,580 | 43' x 60' | 18' | 275 | 154 | 150 | 174 | N/A | N/A |
| Jasmine BCD | 3,440 | 43' x 80' | 18' | 366 | 205 | 210 | 232 | N/A | N/A |
| Jasmine BF | 2,580 | 86' x 30' | 18' | 275 | 154 | 150 | 174 | N/A | N/A |
| Jasmine BCFG | 5,160 | 86' x 60' | 18' | 549 | 307 | 310 | 348 | N/A | N/A |
| Jasmine BCDFGH | 6,880 | 86' x 80' | 18' | 733 | 409 | 410 | 464 | N/A | N/A |
| Jasmine C | 1,290 | 43' x 30' | 18' | 138 | 77 | 80 | 87 | 34 | 42 |
| Jasmine CD | 2,150 | 43' x 50' | 18' | 229 | 128 | 130 | 145 | N/A | N/A |
| Jasmine CG | 2,580 | 86' x 30' | 18' | 275 | 154 | 150 | 174 | N/A | N/A |
| Jasmine CDGH | 4,300 | 86' x 50' | 18' | 458 | 256 | 260 | 290 | N/A | N/A |
| Jasmine D | 860 | 43' x 20' | 18' | 92 | 51 | 50 | 58 | 34 | 40 |
| Jasmine DH | 1,720 | 86' x 20' | 18' | 183 | 102 | 100 | 116 | N/A | N/A |
| Jasmine E | 1,247 | 43' x 29' | 18' | 153 | 86 | 90 | 97 | 34 | 44 |
| Jasmine EF | 2,537 | 43' x 59' | 18' | 295 | 165 | 170 | 187 | N/A | N/A |
| Jasmine EFG | 3,827 | 43' x 89' | 18' | 433 | 242 | 240 | 274 | N/A | N/A |
| Jasmine EFGH | 4,687 | 43' x 109' | 18' | 556 | 311 | 310 | 352 | N/A | N/A |
| Jasmine F | 1,290 | 43' x 30' | 18' | 138 | 77 | 80 | 87 | 34 | 42 |
| Jasmine FG | 2,580 | 43' x 60' | 18' | 275 | 154 | 150 | 174 | N/A | N/A |
| Jasmine FGH | 3,440 | 43' x 80' | 18' | 367 | 205 | 210 | 233 | N/A | N/A |
| Jasmine G | 1,290 | 43' x 30' | 18' | 138 | 77 | 80 | 87 | 34 | 42 |
| Jasmine GH | 2,150 | 43' x 50' | 18' | 229 | 128 | 130 | 145 | N/A | N/A |
| Jasmine H | 860 | 43' x 20' | 18' | 128 | 72 | 70 | 81 | 34 | 42 |
| Jasmine Reg Desk North (Office) | 516 | 43' x 12' | 12' | N/A | N/A | N/A | N/A | N/A | N/A |
| Jasmine Reg Desk North (Desk) | 380 | 38' x 10' | N/A | N/A | N/A | N/A | N/A | N/A | N/A |
| Jasmine Reg Desk South (Office) | 516 | 43' x 12' | 12' | N/A | N/A | N/A | N/A | N/A | N/A |
| Jasmine Reg Desk South (Desk) | 380 | 38' x 10' | N/A | N/A | N/A | N/A | N/A | N/A | N/A |
| Jasmine Foyer North | 9,000 | 300' x 30' | N/A | N/A | N/A | N/A | 600 | N/A | N/A |
| Jasmine Foyer South | 7,200 | 240' x 30' | N/A | N/A | N/A | N/A | 480 | N/A | N/A |

Length = North to South, Width = East to West



Classroom seating based on 3 people per 6' table.
Capacities are subject to change based on allowances for head tables, staging, audiovisual, and catering requirements.

CAPACITIES SOUTH CONVENTION CENTER - LEVEL 3 CONTINUED

| | Square Feet | Dimensions (LxW) | Ceiling Height | Theatre | Classroom | Rounds of 10 | Reception | Conference | Hollow Square |
|------------------------------|-------------|------------------|----------------|---------|-----------|--------------|-----------|------------|---------------|
| Banyan (includes A, B, C, D) | 5,148 | 44' x 117' | 18' | 542 | 303 | 300 | 343 | N/A | N/A |
| Banyan A | 1,364 | 44' x 31' | 18' | 144 | 80 | 80 | 91 | 36 | 44 |
| Banyan AB | 2,684 | 44' x 61' | 18' | 283 | 158 | 160 | 179 | N/A | N/A |
| Banyan ABC | 4,004 | 44' x 91' | 18' | 421 | 236 | 240 | 267 | N/A | N/A |
| Banyan B | 1,320 | 44' x 30' | 18' | 139 | 78 | 80 | 88 | 36 | 44 |
| Banyan BC | 2,640 | 44' x 60' | 18' | 277 | 155 | 160 | 175 | N/A | N/A |
| Banyan BCD | 3,784 | 44' x 86' | 18' | 398 | 223 | 220 | 252 | N/A | N/A |
| Banyan C | 1,320 | 44' x 30' | 18' | 139 | 78 | 80 | 88 | 36 | 44 |
| Banyan CD | 2,464 | 44' x 56' | 18' | 259 | 145 | 150 | 164 | N/A | N/A |
| Banyan D | 1,144 | 44' x 26' | 18' | 120 | 67 | 70 | 76 | 36 | 42 |
| Banyan E | 896 | 28' x 32' | 18' | 98 | 55 | 60 | 62 | 22 | 32 |
| Banyan F | 896 | 28' x 32' | 18' | 82 | 46 | 50 | 52 | 22 | 32 |

| | Square Feet | Dimensions (LxW) | Ceiling Height | Theatre | Classroom | Rounds of 10 | Reception | Conference | Hollow Square |
|------------------------|-------------|------------------|----------------|---------|-----------|--------------|-----------|------------|---------------|
| South Seas Ballroom | 48,327 | 267' x 181' | 26' | 5,115 | 2,858 | 2,860 | 3,240 | N/A | N/A |
| Corridor 1 | 2,700 | 135' x 20' | 26' | N/A | N/A | N/A | N/A | N/A | N/A |
| Corridor 2 | 2,300 | 115' x 20' | 26' | N/A | N/A | N/A | N/A | N/A | N/A |
| Corridor 3 | 2,160 | 135' x 16' | 26' | N/A | N/A | N/A | N/A | N/A | N/A |
| Corridor 4 | 1,840 | 115' x 16' | 26' | N/A | N/A | N/A | N/A | N/A | N/A |
| Corridor 5 | 1,224 | 17' x 72' | 26' | N/A | N/A | N/A | N/A | N/A | N/A |
| Corridor 6 | 578 | 17' x 34' | 26' | N/A | N/A | N/A | N/A | N/A | N/A |
| Corridor 7 | 663 | 17' x 39' | 26' | N/A | N/A | N/A | N/A | N/A | N/A |
| South Seas A | 2,448 | 72' x 34' | 26' | 261 | 146 | 150 | 166 | 54 | 62 |
| South Seas AB | 4,590 | 135' x 34' | 26' | 490 | 274 | 270 | 310 | N/A | N/A |
| South Seas ABC | 6,970 | 205' x 34' | 26' | 743 | 415 | 420 | 470 | N/A | N/A |
| South Seas ABCD | 9,078 | 267' x 34' | 26' | 970 | 542 | 540 | 614 | N/A | N/A |
| South Seas ABE | 17,010 | 135' x 126' | 26' | 1,794 | 1,003 | 1,000 | 1,136 | N/A | N/A |
| South Seas ABCDEF | 33,642 | 267' x 126' | 26' | 3,548 | 1,983 | 1,980 | 2,247 | N/A | N/A |
| South Seas ABEGH | 24,435 | 135' x 181' | 26' | 2,586 | 1,445 | 1,450 | 1,638 | N/A | N/A |
| South Seas B | 2,142 | 63' x 34' | 26' | 225 | 126 | 130 | 143 | 50 | 60 |
| South Seas BC | 4,522 | 133' x 34' | 26' | 481 | 269 | 270 | 305 | N/A | N/A |
| South Seas BCD | 6,630 | 195' x 34' | 26' | 708 | 396 | 400 | 448 | N/A | N/A |
| South Seas C | 1,802 | 53' x 34' | 26' | 200 | 112 | 110 | 127 | 44 | 52 |
| South Seas CD | 3,910 | 115' x 34' | 26' | 418 | 233 | 230 | 264 | N/A | N/A |
| South Seas CDF | 14,490 | 115' x 126' | 26' | 1,528 | 854 | 850 | 968 | N/A | N/A |
| South Seas CDFIJ | 20,815 | 115' x 181' | 26' | 2,419 | 1,352 | 1,350 | 1,532 | N/A | N/A |
| South Seas D | 2,108 | 62' x 34' | 26' | 218 | 122 | 120 | 138 | 48 | 56 |
| South Seas E | 9,720 | 135' x 72' | 26' | 1,023 | 572 | 570 | 648 | N/A | N/A |
| South Seas EF | 19,224 | 267' x 72' | 26' | 2,024 | 1,131 | 1,130 | 1,282 | N/A | N/A |
| South Seas EGH | 17,145 | 135' x 127' | 26' | 1,808 | 1,010 | 1,010 | 1,145 | N/A | N/A |
| South Seas EFGHIJ | 33,909 | 267' x 127' | 26' | 3,576 | 1,999 | 2,000 | 2,265 | N/A | N/A |
| South Seas F | 8,280 | 115' x 72' | 26' | 872 | 487 | 490 | 552 | N/A | N/A |
| South Seas FIJ | 14,605 | 115' x 127' | 26' | 1,540 | 861 | 860 | 976 | N/A | N/A |
| South Seas G | 2,808 | 72' x 39' | 26' | 288 | 161 | 161 | 182 | 54 | 66 |
| South Seas GH | 5,265 | 135' x 39' | 26' | 561 | 314 | 310 | 355 | N/A | N/A |
| South Seas GHI | 7,995 | 205' x 39' | 26' | 850 | 475 | 480 | 538 | N/A | N/A |
| South Seas GHIJ | 10,413 | 267' x 39' | 26' | 1,110 | 620 | 620 | 703 | N/A | N/A |
| South Seas H | 2,457 | 63' x 39' | 26' | 274 | 153 | 150 | 174 | 52 | 64 |
| South Seas HI | 5,187 | 133' x 39' | 26' | 551 | 308 | 310 | 349 | N/A | N/A |
| South Seas HIJ | 7,605 | 195' x 39' | 26' | 811 | 453 | 450 | 513 | N/A | N/A |
| South Seas I | 2,067 | 53' x 39' | 26' | 229 | 128 | 130 | 145 | 44 | 56 |
| South Seas IJ | 4,485 | 115' x 39' | 26' | 478 | 267 | 270 | 303 | N/A | N/A |
| South Seas J | 2,418 | 62' x 39' | 26' | 254 | 142 | 140 | 161 | 48 | 60 |
| South Seas Foyer North | 15,300 | 300' x 51' | N/A | N/A | N/A | N/A | 1,033 | N/A | N/A |
| South Seas Foyer West | 5,400 | 180' x 30' | N/A | N/A | N/A | N/A | 360 | N/A | N/A |

Length = North to South, Width = East to West

Classroom seating based on 3 people per 6' table.

Capacities are subject to change based on allowances for head tables, staging, audiovisual, and catering requirements.

CAPACITIES SOUTH CONVENTION CENTER - LEVEL 3 CONTINUED

| | Square Feet | Dimensions (LxW) | Ceiling Height | Theatre | Classroom | Rounds of 10 | Reception | Conference | Hollow Square |
|------------|-------------|------------------|----------------|---------|-----------|--------------|-----------|------------|---------------|
| Palm | | | | | | | | | |
| Palm A | 2,109 | 57' x 37' | 18' | 217 | 121 | 120 | 138 | 44 | 52 |
| Palm B | 2,109 | 57' x 37' | 18' | 229 | 128 | 130 | 145 | 46 | 58 |
| Palm C | 2,109 | 57' x 37' | 18' | 229 | 128 | 130 | 145 | 46 | 58 |
| Palm D | 2,109 | 57' x 37' | 18' | 229 | 128 | 130 | 145 | 46 | 58 |
| Palm E | 836 | 38' x 22' | 18' | 93 | 52 | 50 | 59 | 30 | 36 |
| Palm F | 722 | 38' x 19' | 18' | 83 | 46 | 50 | 53 | 30 | 36 |
| Palm G | 570 | 38' x 15' | 18' | 68 | 38 | 40 | 43 | 30 | 34 |
| Palm H | 1,829 | 59' x 31' | 18' | 217 | 121 | 120 | 138 | 48 | 58 |
| Palm Foyer | 41,850 | 450' x 93' | N/A | N/A | N/A | N/A | 2,800 | N/A | N/A |

Length = North to South, Width = East to West



Classroom seating based on 3 people per 6' table.

Capacities are subject to change based on allowances for head tables, staging, audiovisual, and catering requirements.

NORTH CONVENTION CENTER LOWER LEVEL

CAPACITIES NORTH CONVENTION CENTER

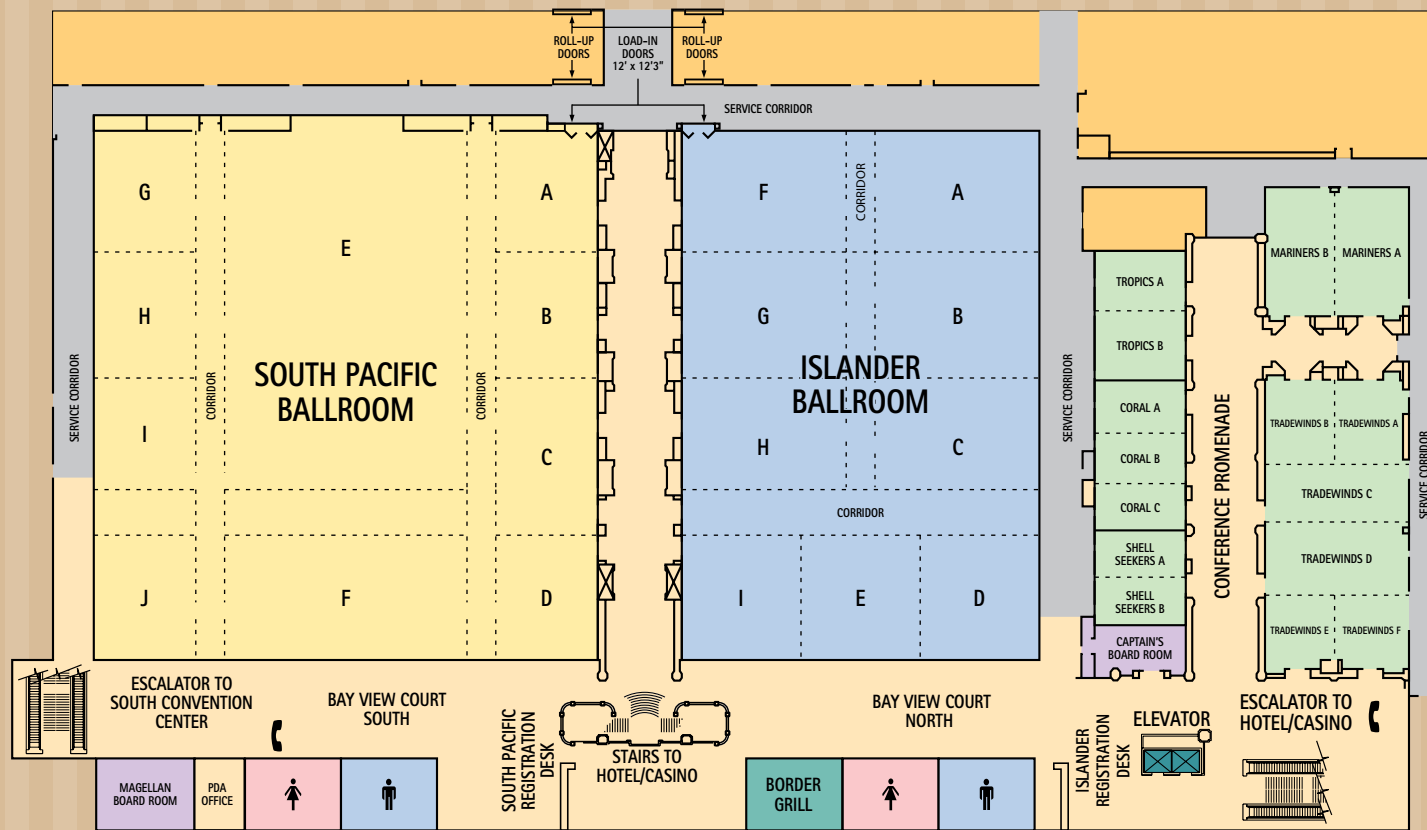

Map Legend

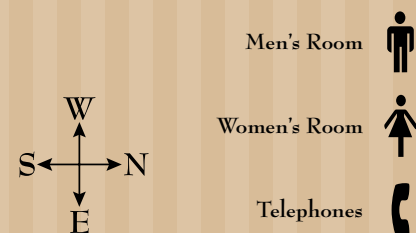

| | Square Feet | Dimensions (LxW) | Ceiling Height | Theatre | Classroom | Rounds of 10 | Reception | Conference | Hollow Square |
|-------------------------------------|-------------|------------------|----------------|---------|-----------|--------------|-----------|------------|---------------|
| Captains Boardroom | 756 | 36' x 21' | 16' | N/A | N/A | N/A | N/A | 12 | N/A |
| Magellan Boardroom | 884 | 26' x 34' | 12' | N/A | N/A | N/A | N/A | 16 | N/A |
| South Pacific Ballroom | 44,496 | 206' x 216' | 26' | 4,728 | 2,642 | 2,640 | 2,994 | N/A | N/A |
| Corridor 1 | 1,992 | 12' x 166' | 26' | N/A | N/A | N/A | N/A | N/A | N/A |
| Corridor 2 | 600 | 12' x 50' | 26' | N/A | N/A | N/A | N/A | N/A | N/A |
| Corridor 3 | 1,881 | 99' x 19' | 26' | N/A | N/A | N/A | N/A | N/A | N/A |
| Corridor 4 | 1,764 | 42' x 19' | 26' | N/A | N/A | N/A | N/A | N/A | N/A |
| Corridor 5 | 228 | 12' x 147' | 26' | N/A | N/A | N/A | N/A | N/A | N/A |
| Corridor 6 | 600 | 12' x 50' | 26' | N/A | N/A | N/A | N/A | N/A | N/A |
| Corridor 7 | 798 | 12' x 19' | 26' | N/A | N/A | N/A | N/A | N/A | N/A |
| South Pacific A | 2,050 | 41' x 50' | 26' | 217 | 121 | 120 | 137 | 36 | 48 |
| South Pacific AB | 4,100 | 41' x 100' | 26' | 437 | 244 | 240 | 277 | N/A | N/A |
| South Pacific ABC | 6,806 | 41' x 166' | 26' | 724 | 405 | 410 | 459 | N/A | N/A |
| South Pacific ABCD | 8,856 | 41' x 216' | 26' | 944 | 528 | 530 | 598 | N/A | N/A |
| South Pacific ABCDEF | 32,832 | 152' x 216' | 26' | 3,486 | 1,948 | 1,950 | 2,208 | N/A | N/A |
| South Pacific ABCDEGHI | 34,196 | 206' x 166' | 26' | 3,632 | 2,030 | 2,032 | 2,300 | N/A | N/A |
| South Pacific B | 2,050 | 41' x 50' | 26' | 218 | 122 | 120 | 138 | 36 | 48 |
| South Pacific BC | 4,756 | 41' x 116' | 26' | 505 | 282 | 280 | 320 | N/A | N/A |
| South Pacific BCD | 2,706 | 41' x 166' | 26' | 724 | 405 | 410 | 459 | N/A | N/A |
| South Pacific C | 2,706 | 41' x 66' | 26' | 284 | 159 | 160 | 180 | 46 | 62 |
| South Pacific CD | 4,756 | 41' x 116' | 26' | 505 | 282 | 280 | 320 | N/A | N/A |
| South Pacific D | 2,050 | 41' x 50' | 26' | 218 | 122 | 120 | 138 | 36 | 48 |
| South Pacific DF | 7,600 | 152' x 50' | 26' | 804 | 451 | 449 | 508 | N/A | N/A |
| South Pacific CFJ | 10,300 | 206' x 50' | 26' | 1,089 | 612 | 606 | 689 | N/A | N/A |
| South Pacific E | 14,553 | 99' x 147' | 26' | 1,532 | 856 | 860 | 970 | N/A | N/A |
| South Pacific EF | 21,384 | 99' x 216' | 26' | 2,255 | 1,260 | 1,260 | 1,428 | N/A | N/A |
| South Pacific EFGHIJ | 33,048 | 153' x 216' | 26' | 3,503 | 1,957 | 1,960 | 2,218 | N/A | N/A |
| South Pacific EGHI | 22,491 | 153' x 147' | 26' | 2,356 | 1,323 | 1,309 | 1,519 | N/A | N/A |
| South Pacific F | 4,950 | 99' x 50' | 26' | 521 | 291 | 290 | 330 | N/A | N/A |
| South Pacific FJ * | 7,650 | 153' x 50' | 26' | 808 | 451 | 450 | 512 | N/A | N/A |
| South Pacific G | 2,100 | 42' x 50' | 26' | 220 | 123 | 120 | 139 | 36 | 48 |
| South Pacific GH | 4,200 | 42' x 100' | 26' | 443 | 247 | 250 | 280 | N/A | N/A |
| South Pacific GHI | 6,174 | 42' x 147' | 26' | 649 | 363 | 360 | 411 | N/A | N/A |
| South Pacific GHIJ | 9,072 | 42' x 216' | 26' | 956 | 534 | 530 | 605 | N/A | N/A |
| South Pacific H | 2,100 | 42' x 50' | 26' | 221 | 123 | 120 | 140 | 36 | 48 |
| South Pacific HI | 4,074 | 42' x 97' | 26' | 427 | 239 | 240 | 271 | N/A | N/A |
| South Pacific HIJ | 6,972 | 42' x 166' | 26' | 733 | 409 | 410 | 464 | N/A | N/A |
| South Pacific I | 1,974 | 42' x 47' | 26' | 204 | 114 | 120 | 129 | 36 | 48 |
| South Pacific IJ | 4,872 | 42' x 116' | 26' | 511 | 285 | 290 | 324 | N/A | N/A |
| South Pacific J | 2,100 | 42' x 50' | 26' | 221 | 123 | 120 | 140 | 36 | 48 |
| South Pacific Registration (Office) | 240 | 8' x 30' | 12' | N/A | N/A | N/A | N/A | N/A | N/A |
| South Pacific Registration (Desk) | 192 | 8' x 24' | N/A | N/A | N/A | N/A | N/A | N/A | N/A |

| | Square Feet | Dimensions (LxW) | Ceiling Height | Theatre | Classroom | Rounds of 10 | Reception | Conference | Hollow Square |
|-------------------|-------------|------------------|----------------|---------|-----------|--------------|-----------|------------|---------------|
| Islander Ballroom | 31,536 | 146' x 216' | 26' | 3,351 | 1,873 | 1,870 | 2,123 | N/A | N/A |
| Corridor 1 | 600 | 12' x 50' | 26' | N/A | N/A | N/A | N/A | N/A | N/A |
| Corridor 2 | 600 | 12' x 50' | 26' | N/A | N/A | N/A | N/A | N/A | N/A |
| Corridor 3 | 564 | 12' x 47' | 26' | N/A | N/A | N/A | N/A | N/A | N/A |
| Corridor 4 | 2,774 | 146' x 19' | 26' | N/A | N/A | N/A | N/A | N/A | N/A |
| Islander A | 3,350 | 67' x 50' | 26' | 355 | 199 | 200 | 225 | 40 | 66 |
| Islander AB | 6,700 | 67' x 100' | 26' | 716 | 400 | 400 | 453 | N/A | N/A |
| Islander ABC | 9,849 | 67' x 147' | 26' | 1,050 | 587 | 590 | 665 | N/A | N/A |
| Islander ABCDFGH | 21,462 | 146' x 147' | 26' | 2,278 | 1,273 | 1,270 | 1,443 | N/A | N/A |
| Islander ABFG | 14,600 | 146' x 100' | 26' | 1,554 | 868 | 870 | 984 | N/A | N/A |
| Islander AF | 7,300 | 146' x 50' | 26' | 771 | 431 | 430 | 488 | N/A | N/A |
| Islander B | 3,350 | 67' x 50' | 26' | 355 | 199 | 200 | 225 | 40 | 66 |
| Islander BC | 6,499 | 67' x 97' | 26' | 689 | 385 | 390 | 436 | N/A | N/A |
| Islander BCGH * | 14,162 | 146' x 97' | 26' | 1,496 | 836 | 840 | 947 | N/A | N/A |
| Islander BG * | 7,300 | 146' x 50' | 26' | 771 | 431 | 430 | 488 | N/A | N/A |

Length = North to South, Width = East to West

Classroom seating based on 3 people per 6' table.

Capacities are subject to change based on allowances for head tables, staging, audiovisual, and catering requirements.

*Some room combinations may limit access to other rooms.

CAPACITIES NORTH CONVENTION CENTER

| | Square Feet | Dimensions (LxW) | Ceiling Height | Theatre | Classroom | Rounds of 10 | Reception | Conference | Hollow Square |
|--------------------------------|-------------|------------------|----------------|---------|-----------|--------------|-----------|------------|---------------|
| Islander BCDEGHI * | 24,236 | 146' x 166' | 26' | 2,571 | 1,437 | 1,470 | 1,629 | N/A | N/A |
| Islander C | 3,149 | 67' x 47' | 26' | 330 | 185 | 190 | 209 | 40 | 66 |
| Islander CDEHI * | 16,936 | 146' x 116' | 26' | 1,789 | 1,000 | 1,000 | 1,133 | N/A | N/A |
| Islander CH * | 6,862 | 146' x 47' | 26' | 717 | 401 | 400 | 454 | N/A | N/A |
| Islander D | 2,400 | 48' x 50' | 26' | 247 | 138 | 138 | 157 | 28 | 48 |
| Islander DE | 4,950 | 99' x 50' | 26' | 520 | 290 | 290 | 329 | N/A | N/A |
| Islander DEI | 7,300 | 146' x 50' | 26' | 771 | 431 | 430 | 488 | N/A | N/A |
| Islander E | 2,550 | 51' x 50' | 26' | 266 | 149 | 150 | 168 | 34 | 48 |
| Islander EI | 4,850 | 97' x 50' | 26' | 517 | 289 | 290 | 327 | N/A | N/A |
| Islander F | 3,350 | 67' x 50' | 26' | 353 | 197 | 200 | 223 | 40 | 66 |
| Islander FG | 6,700 | 67' x 100' | 26' | 716 | 400 | 400 | 453 | N/A | N/A |
| Islander FGH | 9,849 | 67' x 147' | 26' | 1,050 | 587 | 590 | 665 | N/A | N/A |
| Islander G | 3,350 | 67' x 50' | 26' | 353 | 197 | 200 | 223 | 40 | 66 |
| Islander GH | 6,499 | 67' x 97' | 26' | 684 | 382 | 380 | 433 | N/A | N/A |
| Islander H | 3,149 | 67' x 47' | 26' | 330 | 185 | 180 | 209 | 40 | 66 |
| Islander I | 2,350 | 47' x 50' | 26' | 249 | 139 | 140 | 157 | 28 | 48 |
| Islander Registration (Office) | 204 | 12' x 17' | 12' | N/A | N/A | N/A | N/A | N/A | N/A |
| Islander Registration (Desk) | 200 | 8' x 25' | N/A | N/A | N/A | N/A | N/A | N/A | N/A |

| | Square Feet | Dimensions (LxW) | Ceiling Height | Theatre | Classroom | Rounds of 10 | Reception | Conference | Hollow Square |
|-----------------|-------------|------------------|----------------|---------|-----------|--------------|-----------|------------|---------------|
| Mariners | 3,068 | 59' x 52' | 14' | 329 | 184 | 180 | 208 | 40 | 60 |
| Mariners A | 1,612 | 31' x 52' | 14' | 170 | 95 | 100 | 108 | 34 | 44 |
| Mariners B | 1,456 | 28' x 52' | 14' | 156 | 87 | 90 | 99 | 34 | 44 |
| Tradewinds | 6,844 | 58' x 118' | 14' | 741 | 414 | 410 | 469 | N/A | N/A |
| Tradewinds A | 952 | 28' x 34' | 14' | 101 | 56 | 60 | 64 | 28 | 36 |
| Tradewinds AB | 1,904 | 56' x 34' | 14' | 101 | 56 | 60 | 64 | 28 | 36 |
| Tradewinds ABC | 3,248 | 56' x 58' | 14' | 204 | 114 | 110 | 129 | N/A | N/A |
| Tradewinds ABCD | 4,928 | 56' x 88' | 14' | 349 | 195 | 200 | 221 | N/A | N/A |
| Tradewinds B | 952 | 28' x 34' | 14' | 529 | 296 | 300 | 335 | N/A | N/A |
| Tradewinds C | 1,416 | 59' x 24' | 14' | 147 | 82 | 80 | 93 | 40 | 48 |
| Tradewinds CD | 3,186 | 59' x 54' | 14' | 335 | 187 | 190 | 212 | N/A | N/A |
| Tradewinds CDEF | 4,897 | 59' x 83' | 14' | 521 | 291 | 290 | 330 | N/A | N/A |
| Tradewinds D | 1,770 | 59' x 30' | 14' | 185 | 103 | 100 | 117 | 40 | 56 |
| Tradewinds DEF | 3,481 | 59' x 59' | 14' | 374 | 209 | 210 | 237 | N/A | N/A |
| Tradewinds E | 812 | 28' x 29' | 14' | 88 | 49 | 50 | 56 | 20 | 24 |
| Tradewinds EF | 1,711 | 59' x 29' | 14' | 185 | 103 | 100 | 117 | N/A | N/A |
| Tradewinds F | 899 | 31' x 29' | 14' | 95 | 53 | 50 | 60 | 20 | 24 |
| Tropics | 1,908 | 36' x 53' | 14' | 203 | 114 | 110 | 129 | 34 | 48 |
| Tropics A | 864 | 36' x 24' | 14' | 94 | 52 | 50 | 59 | 24 | 24 |
| Tropics B | 1,008 | 36' x 28' | 14' | 109 | 60 | 60 | 69 | 24 | 24 |
| Coral | 2,160 | 36' x 60' | 14' | 233 | 130 | 130 | 147 | 34 | 48 |
| Coral A | 720 | 36' x 20' | 14' | 79 | 44 | 40 | 50 | 22 | 24 |
| Coral AB | 1,476 | 36' x 41' | 14' | 155 | 87 | 90 | 98 | N/A | N/A |
| Coral B | 756 | 36' x 21' | 14' | 79 | 44 | 40 | 50 | 22 | 24 |
| Coral BC | 1,440 | 36' x 40' | 14' | 152 | 85 | 90 | 96 | N/A | N/A |
| Coral C | 684 | 36' x 19' | 14' | 72 | 40 | 40 | 46 | 22 | 24 |
| Shell Seekers | 1,368 | 36' x 38' | 14' | 145 | 81 | 80 | 92 | 28 | 36 |
| Shell Seekers A | 684 | 36' x 19' | 14' | 72 | 40 | 40 | 45 | 22 | 24 |
| Shell Seekers B | 684 | 36' x 19' | 14' | 72 | 40 | 40 | 45 | 22 | 24 |

Length = North to South, Width = East to West



Classroom seating based on 3 people per 6' table. *Some room combinations may limit access to other rooms. Capacities are subject to change based on allowances for head tables, staging, audiovisual, and catering requirements.



-  Awarded 5 Green Keys, the highest rating from the Green Key Eco-Rating Program.
-  Over 91% of all material from the Mandalay Bay Convention Center is recycled.
-  Member of Convene Green Alliance.
-  100% sustainable and/or organic menus are available for your banquets.
-  Water is served upon request at banquet breakfasts and lunches.
-  Motion-sensitive and water-saving faucets have been installed in all public restrooms.
-  All recycling is done back of house for our guests' convenience and aesthetic value.
-  Linen reuse program in both the Mandalay Bay Tower and THEhotel.
-  Replaced over 1,000 light fixtures in the exhibit halls to energy-efficient linear fluorescents enabling show organizers to have flexibility with lighting levels and customization of areas while reducing total overall wattage and reduction of heat.
-  eBilling is used for convention groups to conserve paper, shipping costs and labor.
-  *Trade Show Weekly* voted Mandalay Bay as one of the top Eco-Leaders in the nation.
-  Electricity is conserved by limiting the activation of HVAC to 12 hours prior to the start of an event.
-  New state-of-the-art online exhibitor ordering system, eliminating paper order forms – mandalaybayexhibitorservices.com

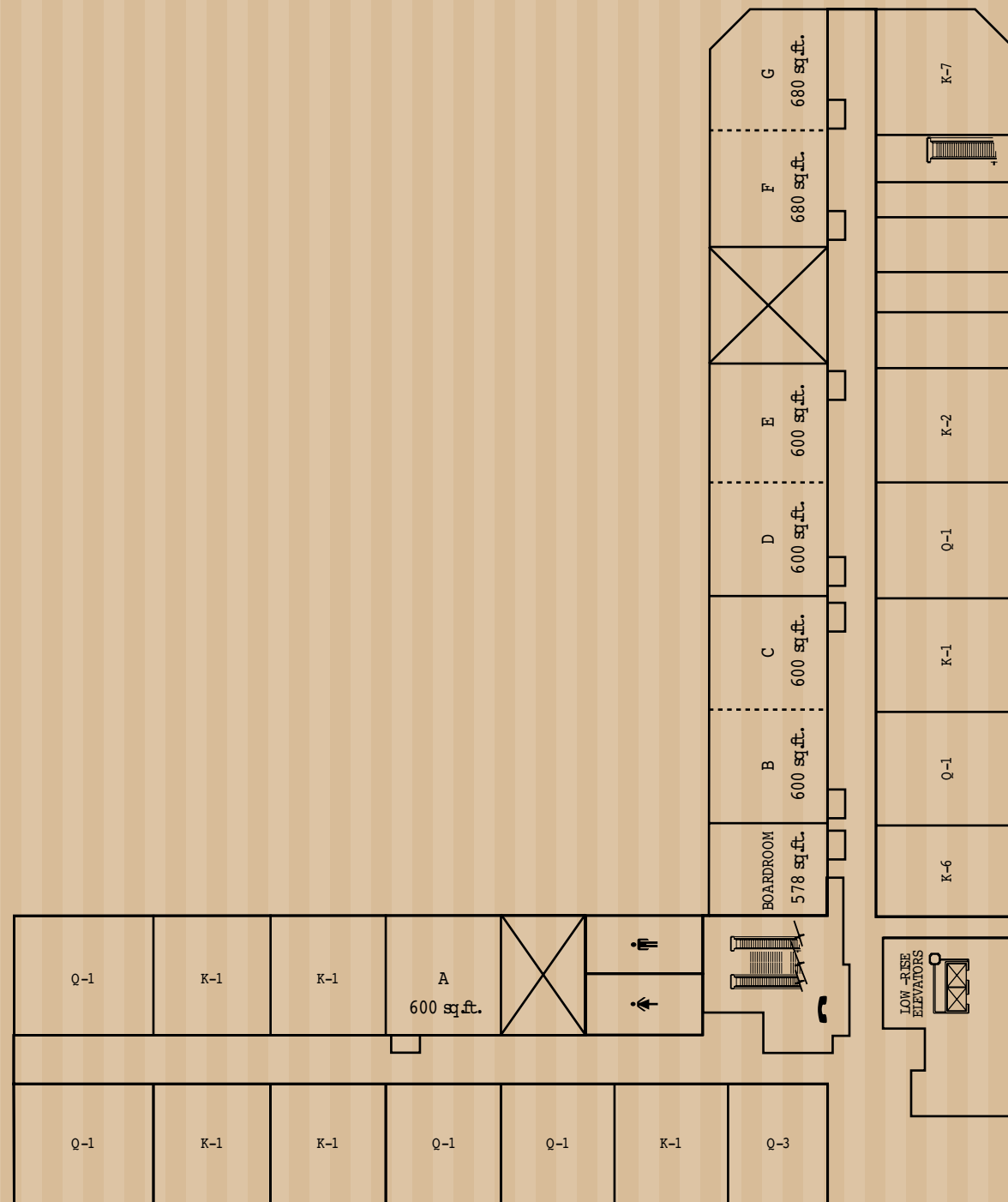

THEhotel is the ideal setting for executive meetings; occupying the first four floors are 32 meeting rooms and 4 boardrooms – approximately 600 square feet and can open to 1,200 square feet. The space is flexible allowing you to reserve an entire floor, including your guest room, for your convenience.

| | Square Feet | Dimensions (LxW) | Ceiling Height | Theatre | Classroom | Rounds of 10 | Reception | Conference | Hollow Square |
|--|-------------|------------------|----------------|---------|-----------|--------------|-----------|------------|---------------|
|--|-------------|------------------|----------------|---------|-----------|--------------|-----------|------------|---------------|

| Silk - 3rd Floor | | | | | | | | | |
|------------------|-------|-----------|-------|-----|-----|-----|-----|-----|-----|
| Silk Boardroom | 578 | 23' x 25' | 7'10" | N/A | N/A | N/A | N/A | 12 | N/A |
| Silk A | 600 | 24' x 25' | 7'10" | 63 | 35 | 40 | 40 | 17 | 22 |
| Silk B | 618 | 25' x 25' | 7'10" | 65 | 36 | 40 | 41 | 17 | 22 |
| Silk BC | 1,237 | 25' x 50' | 7'10" | 130 | 73 | 70 | 82 | N/A | N/A |
| Silk C | 618 | 25' x 25' | 7'10" | 65 | 36 | 40 | 41 | 17 | 22 |
| Silk D | 618 | 25' x 25' | 7'10" | 65 | 36 | 40 | 41 | 17 | 22 |
| Silk DE | 1,212 | 25' x 49' | 7'10" | 128 | 71 | 70 | 81 | N/A | N/A |
| Silk E | 618 | 25' x 25' | 7'10" | 65 | 36 | 40 | 41 | 17 | 22 |
| Silk F | 618 | 25' x 25' | 7'10" | 65 | 36 | 40 | 41 | 19 | 25 |
| Silk FG | 1,239 | 25' x 51' | 7'10" | 130 | 73 | 70 | 83 | N/A | N/A |
| Silk G | 626 | 27' x 25' | 7'10" | 66 | 37 | 40 | 42 | 19 | 25 |

| Mahogany - 4th Floor | | | | | | | | | |
|----------------------|-------|-----------|-------|-----|-----|-----|-----|-----|-----|
| Mahogany Boardroom | 578 | 23' x 25' | 7'10" | N/A | N/A | N/A | N/A | 12 | N/A |
| Mahogany A | 600 | 24' x 25' | 7'10" | 63 | 35 | 40 | 40 | 17 | 22 |
| Mahogany B | 618 | 25' x 25' | 7'10" | 65 | 36 | 40 | 41 | 17 | 22 |
| Mahogany BC | 1,237 | 25' x 50' | 7'10" | 130 | 73 | 70 | 82 | N/A | N/A |
| Mahogany C | 618 | 25' x 25' | 7'10" | 65 | 36 | 40 | 41 | 17 | 22 |
| Mahogany D | 618 | 25' x 25' | 7'10" | 65 | 36 | 40 | 41 | 17 | 22 |
| Mahogany DE | 1,212 | 25' x 49' | 7'10" | 128 | 71 | 70 | 81 | N/A | N/A |
| Mahogany E | 618 | 25' x 25' | 7'10" | 65 | 36 | 40 | 41 | 17 | 22 |
| Mahogany F | 618 | 25' x 25' | 7'10" | 65 | 36 | 40 | 41 | 19 | 25 |
| Mahogany FG | 1,239 | 25' x 51' | 7'10" | 130 | 73 | 70 | 83 | N/A | N/A |
| Mahogany G | 626 | 27' x 25' | 7'10" | 66 | 37 | 40 | 42 | 19 | 25 |

| Granite - 5th Floor | | | | | | | | | |
|---------------------|-------|-----------|-------|-----|-----|-----|-----|-----|-----|
| Granite Boardroom | 578 | 23' x 25' | 7'10" | N/A | N/A | N/A | N/A | 12 | N/A |
| Granite A | 600 | 24' x 25' | 7'10" | 63 | 35 | 40 | 40 | 17 | 22 |
| Granite B | 618 | 25' x 25' | 7'10" | 65 | 36 | 40 | 41 | 17 | 22 |
| Granite BC | 1,237 | 25' x 50' | 7'10" | 130 | 73 | 70 | 82 | N/A | N/A |
| Granite C | 618 | 25' x 25' | 7'10" | 65 | 36 | 40 | 41 | 17 | 22 |
| Granite D | 618 | 25' x 25' | 7'10" | 65 | 36 | 40 | 41 | 17 | 22 |
| Granite DE | 1,212 | 25' x 49' | 7'10" | 128 | 71 | 70 | 81 | N/A | N/A |
| Granite E | 618 | 25' x 25' | 7'10" | 65 | 36 | 40 | 41 | 17 | 22 |
| Granite F | 618 | 25' x 25' | 7'10" | 65 | 36 | 40 | 41 | 19 | 25 |
| Granite FG | 1,239 | 25' x 51' | 7'10" | 130 | 73 | 70 | 83 | N/A | N/A |
| Granite G | 626 | 27' x 25' | 7'10" | 66 | 37 | 40 | 42 | 19 | 25 |

| Marble - 6th Floor | | | | | | | | | |
|--------------------|-------|-----------|-------|-----|-----|-----|-----|-----|-----|
| Marble Boardroom | 578 | 23' x 25' | 7'10" | N/A | N/A | N/A | N/A | 12 | N/A |
| Marble A | 600 | 24' x 25' | 7'10" | 63 | 35 | 40 | 40 | 17 | 22 |
| Marble B | 618 | 25' x 25' | 7'10" | 65 | 36 | 40 | 41 | 17 | 22 |
| Marble BC | 1,237 | 25' x 50' | 7'10" | 130 | 73 | 70 | 82 | N/A | N/A |
| Marble C | 618 | 25' x 25' | 7'10" | 65 | 36 | 40 | 41 | 17 | 22 |
| Marble D | 618 | 25' x 25' | 7'10" | 65 | 36 | 40 | 41 | 17 | 22 |
| Marble DE | 1,212 | 25' x 49' | 7'10" | 128 | 71 | 70 | 81 | N/A | N/A |
| Marble E | 618 | 25' x 25' | 7'10" | 65 | 36 | 40 | 41 | 17 | 22 |
| Marble F | 618 | 25' x 25' | 7'10" | 65 | 36 | 40 | 41 | 19 | 25 |
| Marble FG | 1,239 | 25' x 51' | 7'10" | 130 | 73 | 70 | 83 | N/A | N/A |
| Marble G | 626 | 27' x 25' | 7'10" | 66 | 37 | 40 | 42 | 19 | 25 |

Classroom seating based on 3 people per 6' table. Capacities are subject to change based on allowances for head tables, staging, audiovisual, and catering requirements.

GET IN. THEN GET UP AND RUNNING.

The Mandalay Bay Convention Center makes load-in and load-out a snap for our trade show customers. We're right off Interstate 15 and Russell Road, and the corridor created by Frank Sinatra Drive makes getting here headache-free. Once the trucks pull in, we have 36 loading docks on 2 decks, capable of handling 36 trailers at once.

We built our Convention Center with the latest technological advances in mind. From single or multimode fiber interconnectivity to Wi-Fi and full broadcast connectivity to a satellite uplink or Vyvx video streaming to high-speed Internet, we're the perfect destination for the high-tech set.

The Mandalay Bay Exhibitor Services Department is the one-stop location for all your exhibitors' needs. Whether they want information technology services, telecommunications products, audiovisual equipment, rigging services, electrical/plumbing, food and beverage, janitorial service, floral design, entertainment planning, or the use of our full-service Convention Business Center, we have everything to make their show a success.

For further information, contact Mandalay Bay Exhibitor Services at: 855.408.1349 or mandalaybayexhibitorservices.com.

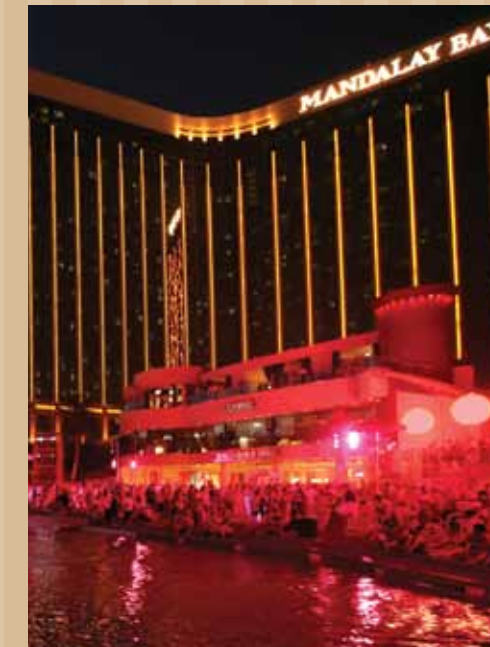
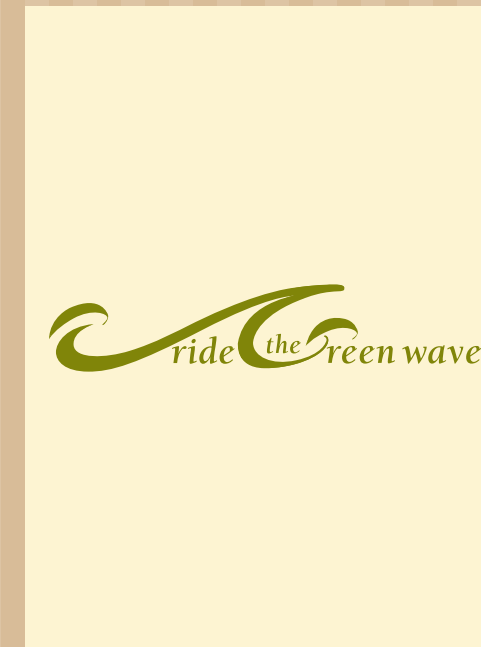



For Hotel Sales information, call 877.632.7900
3950 Las Vegas Boulevard South, Las Vegas, Nevada 89119-1006
mandalaybay.com/conventions